



Contents

Introduction	
Safety instructions	1
Before use, cleaning & maintenance	2
Technical data	2
Warranty	Turn Page
Box contents	3
Operation instructions	
Description and features	3
Wiring guideline	4
Installation	
Hanging requirements	4
Mounting requirements	5
Troubleshooting	5

Safety instructions

WARNING - When using electrical appliances, basic safety precautions should always be followed. Failure to comply with these instructions may cause a fire, electrical shocks or other injury to persons or property.

- Children of less than 3 years should be kept away unless continuously supervised.
- Children between 3 and 8 years old should only be allowed to switch the appliance on/off, provided that it has been correctly installed in its intended operating position and they have been given supervision or instruction concerning the safe use of the appliance and understand the hazards involved. They should not plug in, regulate, perform maintenance or clean the appliance.
- DO NOT position the heater on soft surfaces or where openings may become blocked. Ensure the base is fitted and fully assembled, and the unit is upright on a flat stable surface before operating. This heater is designed for use on Patios and in Beer gardens & smoking areas. The unit has been IP65 Weatherproof approved; however, to prolong the life of the heater it is strongly recommended that the heater is stored in a dry place during heavy rain and when not in use cover the appliance with the cover provided.
- DO NOT hide the power cord in long grass or leave close to an operating lawnmower. Arrange the cord away from areas where it may be tripped over.
- DO NOT insert or allow objects to touch the heating element and never place anything on the heater safety guard (e.g. towels), as this may damage the heater and could cause an electrical shock or fire. Never use your heater to dry washing. If the heating element has stopped glowing it may still be live, please check that the heat setting indicates the heater is off.
- Always disconnect your appliance from the mains before any cleaning.
- DO NOT use the heater in areas where petrol, paint, or other flammable substances are stored. Do not use this heater in the immediate surroundings of a bath, a shower or a swimming pool.
- Always unplug the heater when not in use. To disconnect from the power supply, grip the plug and pull from the power socket. Never pull by the cord.
- DO NOT direct the heater towards curtains, furniture or other flammable objects and ensure that they are at least 1.5 metre from the front and 0.5 metre from the top and sides.
- Extreme care should be taken when the heater is used near children and pets.
- Do not use the heater with a programmer, timer or any other device that switches the heater on automatically, since a fire risk exists if the heater is covered or positioned incorrectly.

Before use, cleaning & maintenance

- 12 In order to avoid overheating, do not cover the heater. The electrical cord must be fully unwound before use. Heater should not be positioned directly under a socket outlet.
- 13 The front grille is intended to prevent direct access to the heating elements and must be in place when the heater is on.
- 14 This appliance can be used by children aged from 8 years and above and persons with reduced physical, sensory or mental capabilities or lack of experience and knowledge if, they have been given supervision or instruction concerning use of the appliance in a safe way and understand the hazards involved. Children should not play with the appliance. Cleaning and maintenance should not be attempted by children without supervision.
- 15 If the supply cord is damaged, it must be replaced by the manufacturer, its service agent or similarly qualified persons in order to avoid a hazard.
- 16 CAUTION — Some parts of this product can become very hot and cause burns. Particular attention has to be given where children and vulnerable people are present.
- 17 WARNING: This heater is not equipped with a device to control the room temperature. Do not use this heater in small rooms when they are occupied by persons not capable of leaving the room on their own, unless constant supervision is provided.

Before use, cleaning & maintenance

Before use This product has been designed for industrial and commercial use, to heat outdoor or indoor spaces using energy efficient carbon fibre infrared technology. It must only be used for this intended purpose and should be operated according to the instructions included in this manual. Please carefully read all operating and safety instructions before use. Never cover appliance when in operation and ensure that flammable objects (clothes, curtains, etc.) cannot come in close contact with the appliance. You may also find this manual's content at www.warmwatcher.com

Cleaning and maintenance Before cleaning or changing heating tubes, turn the heater off, unplug from the power supply and wait for the unit to cool down.

- 1, To clean the heater use a soft cloth to wipe off any dust. If the heater is very dirty, use a damp cloth and wipe dry. Do not use any cleaning detergents, sprays or other chemicals, as they will damage the unit.
- 2, When the heater is not in use for a long period, clean and place in a cover and store in a dry place.
- 3, If the Aluminium reflector is very dirty use a damp cloth and wipe dry. Do not use any cleaning detergents, sprays or other chemicals, as they will damage the unit. A dirty reflector reduces heater output.

Technical data

Model No.: IHC3000 / IHC3000+ or see Rating Label
Power output : 3000W 220-240V AC ~ 50/60Hz or see Rating Label
Heater watts : 3000W or as per Rating label
Cable length : None / 1-1.9m or as per outer box
Gross weight : 3.4 / 3.9 kgs Net weight : 2.8 / 3.3 kgs
Product Dimension: L70*W17.5*D8.2cm(12.5 with Junction Box)

The product is IP65 industryproof certified. It is designed to withstand tough rain or dusty conditions. We recommend that you should cover the product when not in use for long periods of time with a storage cover — please ask the seller if needed.



Box contents			
A 	B 	C 	D
1 X Heater unit	1 X Thread Jacket	1 X Adjuster for Heating mode	1 X Instruction Manual

Description and features

If there are sponges protecting the heating tube or paper card on the Grille, remove them **BEFORE USE**.

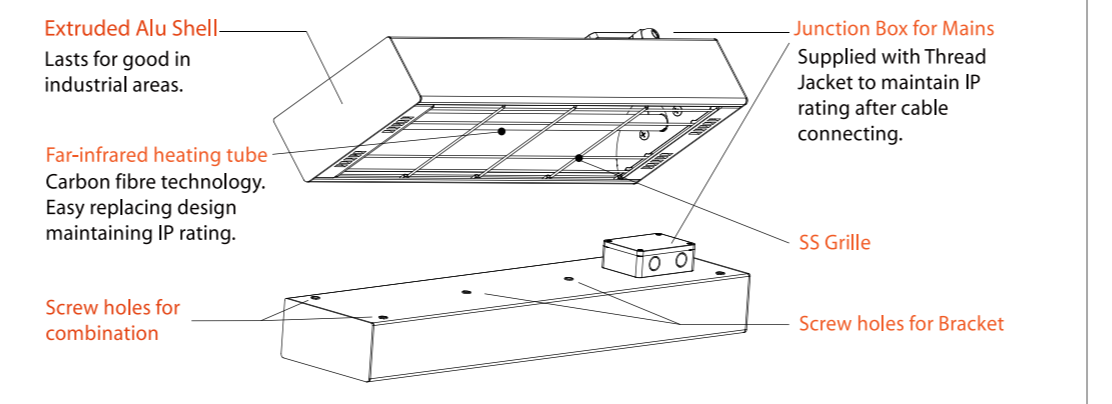

There are two heat-projecting modes -- Focusing and Diffusing. Adjust the position of the tube will provide one of them. The Factory Setting is Focusing.

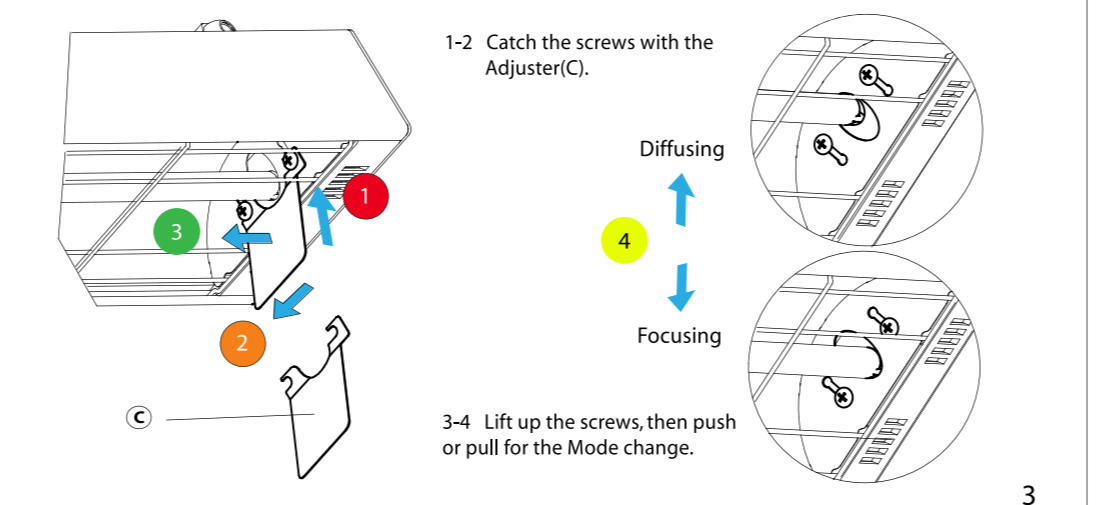

Wiring guideline (IHC3000 - Expert configuration and installation required, please consult a licensed electrician.)

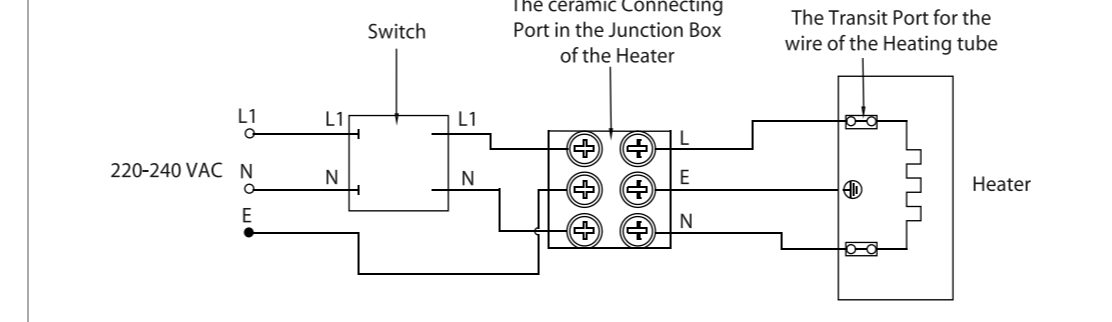
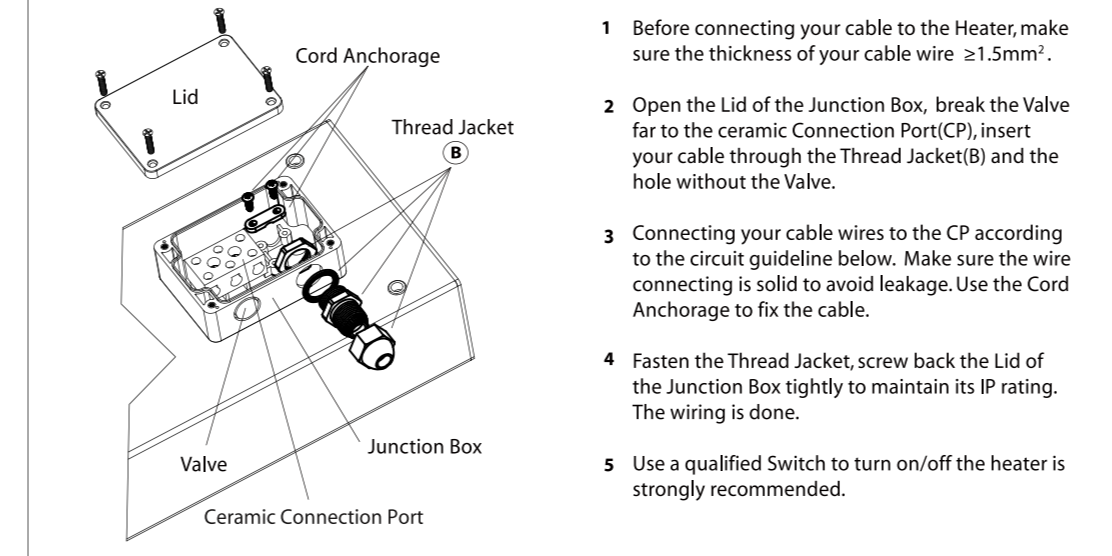

Hanging requirements

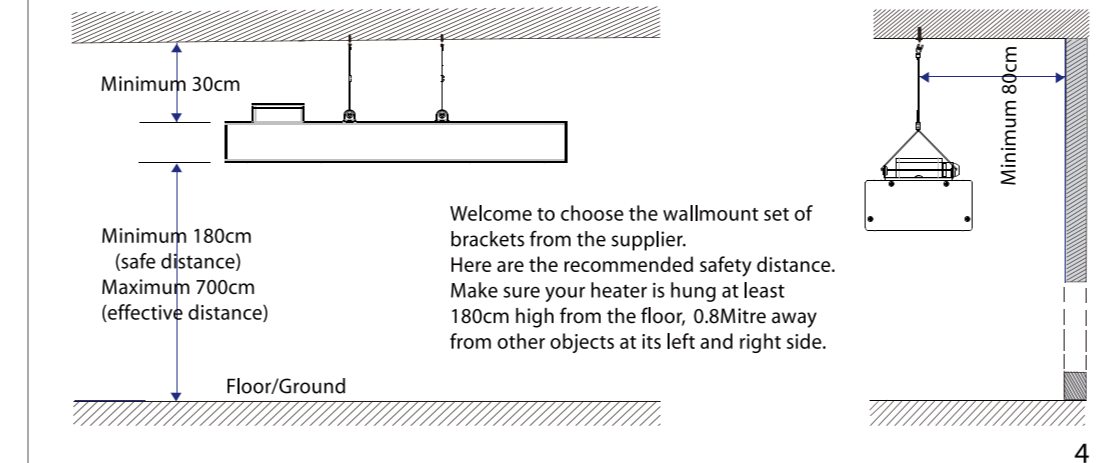

Mounting requirements

Welcome to choose the wallmount set of brackets from the supplier. Here are the recommended safety distance. Make sure your heater is mounted at least 180cm high from the floor, 0.8Mitre away from other objects at its left and right side.

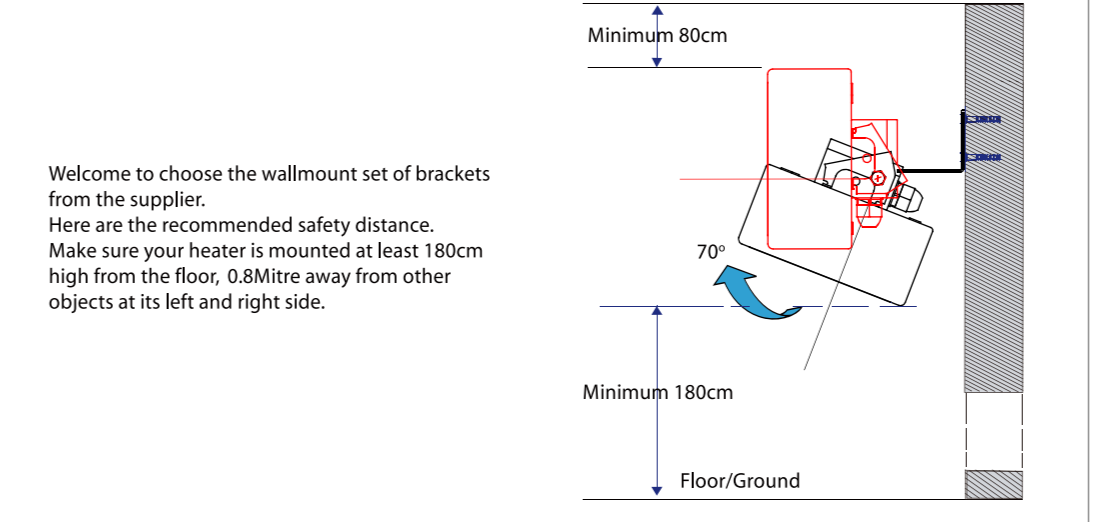

Trouble shooting

Problem	Possible cause	Solution
Heater won't operate	No Power to unit	Check the mains or the electrical socket to restore circuit.
	Power Cord Damaged	Inspect power cable for cuts, breaks and kinks. Replacement power cords and fitting instructions can be obtained from the technical helpdesk – see warranty card.
	Tube Failure	Blown tubes are usually visible. Check for black or white discolouration at either end of the tube. This unit uses specialized high temperature carbon fibre heating tubes only. For replacements, please call the technical helpdesk – see warranty card.

